

Prompter Kit for Tablet

TP-300



Instruction Manual

Rev Date: 03-04-2013 *P/N:* TP-300_E4_A4

WWW.DATAVIDEO.COM

Contents	
Warranty.....	4
Disposal	4
Packing List.....	5
Product Overview.....	6
Features.....	6
Assembly	7
Below Lens Assembly	12
Software Download from the App Store™	14
Android App download from Google play™	14
Tablet / Device Settings	14
Prompter Application Set Up	15
How to quickly add text into a DV Prompter document.....	17
Using the optional wired Remote Control.....	18
How to set up the App for the wired remote control.....	18
Using the optional Bluetooth Remote Control	19
How to charge the Bluetooth remote control	19
How to pair the Bluetooth remote control.....	19
How to set up the App for the Bluetooth remote control.....	19
Cleaning the 60/40 Glass sheet.....	21
Adjusting the lower rail of the prompter frame	22
Specifications	22
Service and Support	23

iPad, iTunes and App Store are trademarks of Apple Inc.

Android and Google play are trademarks of Google Inc.

Disclaimer of Product and Services

The information offered in this instruction manual is intended as a guide only. At all times, Datavideo Technologies will try to give correct, complete and suitable information. However, Datavideo Technologies cannot exclude that some information in this manual, from time to time, may not be correct or may be incomplete. This manual may contain typing errors, omissions or incorrect information. Datavideo Technologies always recommend that you double check the information in this document for accuracy before making any purchase decision or using the product. Datavideo Technologies is not responsible for any omissions or errors, or for any subsequent loss or damage caused by using the information contained within this manual. Further advice on the content of this manual or on the product can be obtained by contacting your local Datavideo Office or dealer.

Warnings and Precautions



1. Read all of these warnings and save them for later reference.
2. Follow all warnings and instructions marked on this unit.
3. Unplug this unit from the wall outlet before cleaning. Do not use liquid or aerosol cleaners. Use a damp cloth for cleaning.
4. Do not use this unit in or near water.
5. Do not place this unit on an unstable cart, stand, or table. The unit may fall, causing serious damage.
6. Slots and openings on the cabinet top, back, and bottom are provided for ventilation. To ensure safe and reliable operation of this unit, and to protect it from overheating, do not block or cover these openings. Do not place this unit on a bed, sofa, rug, or similar surface, as the ventilation openings on the bottom of the cabinet will be blocked. This unit should never be placed near or over a heat register or radiator. This unit should not be placed in a built-in installation unless proper ventilation is provided.
7. This product should only be operated from the type of power source indicated on the marking label of the AC adapter. If you are not sure of the type of power available, consult your Datavideo dealer or your local power company.
8. Do not allow anything to rest on the power cord. Do not locate this unit where the power cord will be walked on, rolled over, or otherwise stressed.
9. If an extension cord must be used with this unit, make sure that the total of the ampere ratings on the products plugged into the extension cord do not exceed the extension cord rating.
10. Make sure that the total amperes of all the units that are plugged into a single wall outlet do not exceed 15 amperes.
11. Never push objects of any kind into this unit through the cabinet ventilation slots, as they may touch dangerous voltage points or short out parts that could result in risk of fire or electric shock. Never spill liquid of any kind onto or into this unit.
12. Except as specifically explained elsewhere in this manual, do not attempt to service this product yourself. Opening or removing covers that are marked "Do Not Remove" may expose you to dangerous voltage points or other risks, and will void your warranty. Refer all service issues to qualified service personnel.
13. Unplug this product from the wall outlet and refer to qualified service personnel under the following conditions:
 - a. When the power cord is damaged or frayed;
 - b. When liquid has spilled into the unit;
 - c. When the product has been exposed to rain or water;
 - d. When the product does not operate normally under normal operating conditions. Adjust only those controls that are covered by the operating instructions in this manual; improper adjustment of other controls may result in damage to the unit and may often require extensive work by a qualified technician to restore the unit to normal operation;
 - e. When the product has been dropped or the cabinet has been damaged;
 - f. When the product exhibits a distinct change in performance, indicating a need for service.

GLASS - Handle with care



This product contains a sheet of 60/40 mirror glass please handle it with care.

To avoid a risk of damage or injury please follow this instruction manual and use caution when transporting, un-packing, cleaning, assembling or dis-assembling this part of the product.

Warranty

Standard Warranty

- Datavideo equipment is guaranteed against any manufacturing defects for one year from the date of purchase.
- The original purchase invoice or other documentary evidence should be supplied at the time of any request for repair under warranty.
- Damage caused by accident, misuse, unauthorized repairs, sand, grit or water is not covered by this warranty.
- All mail or transportation costs including insurance are at the expense of the owner.
- All other claims of any nature are not covered.
- Cables & batteries are not covered under warranty.
- Warranty only valid within the country or region of purchase.
- Your statutory rights are not affected.



Two Year Warranty

- All Datavideo products purchased after 01-Oct.-2008 qualify for a free one year extension to the standard Warranty, providing the product is registered with Datavideo within 30 days of purchase. For information on how to register please visit www.datavideo.com or contact your local Datavideo office or authorized Distributors
- Certain parts with limited lifetime expectancy such as LCD Panels, DVD Drives, Hard Drives are only covered for the first 10,000 hours, or 1 year (whichever comes first).

Any second year warranty claims must be made to your local Datavideo office or one of its authorized Distributors before the extended warranty expires.

Disposal



For EU Customers only - WEEE Marking

This symbol on the product indicates that it should not be treated as household waste. It must be handed over to the applicable take-back scheme for the recycling of Waste Electrical and Electronic Equipment. For more detailed information about the recycling of this product, please contact your local Datavideo office.

Packing List

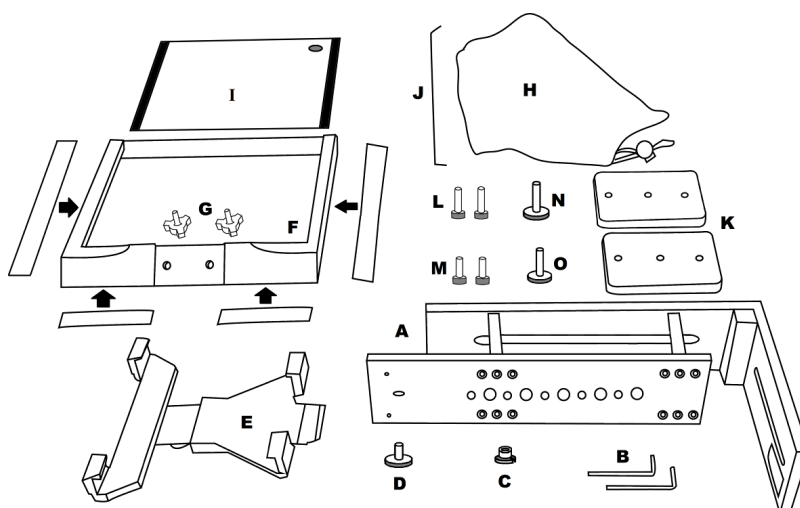

Item	Description	Quantity
A	Prompter Frame	1
B	Hex Tools to tighten Frame screws	2
C	Metal 3/8" to 1/4" adaptor screw for tripod plate <i>This item screws into one of the larger holes on the bottom of the prompter frame to make it compatible with a standard 1/4" screw on a tripod plate.</i>	1
D	Mounting Bracket Screw secures item E to A	1
E	Expandable mounting bracket for tablet	1
F	Glass Frame with matching Velcro straps	1
G	Wing nut screws for securing the Glass Frame	2
H	Cloth Snood/Hood including side curtains and Velcro straps	1
I	60/40 Mirror Glass with Green and Red sticker	1
J	Snood/Hood support wire	1
K	Camera Riser Blocks 15mm thick	2
L	3mm Hex Block Screw long	2
M	2.5mm Hex Block Screw Short	2
N	Camera Riser Screw Long	1
O	Camera Riser Screw Short with two washers and nut	1
P	Instruction Manual	1

NOTE: Depending on your order, your TP-300 kit could have been supplied with one of the following optional remote controls:

- Wired remote for Android™ or iOS™ devices with a headset jack input.
- Bluetooth Wireless remote for Android™ or iOS™ devices.

NOTE: The foam packing within the retail carton has been designed so that it can be easily transferred to an optional hard case for this kit.

Please speak with your supplier or dealer if you wish to purchase an optional remote control or hard case for your prompter kit.

Product Overview

Why struggle with expensive re-takes, on stage talent drifting off script or a presenters' loss of eye contact with the viewing audience? The Datavideo Prompter Kit, TP-300, is designed to help you overcome these problems by converting a tablet computer (*not supplied*) into a low cost and effective prompter.

The Datavideo Prompter Kit TP-300 can be used in either a theatre setting, or a video studio. Prepared scripts or cue sheets can be easily copied and pasted into the DV prompter app software from email and scrolled at a set automatic rate or controlled by a user with the wired/wireless remote for a more natural result. A number of clear fonts, colours and text sizes are available making reading comfortable from a variety of distances.

Features

- Simple software and remote allow users to produce professional results at low cost.
- Special 60/40 Glass allows the presenter to read the script and the camera to see the subject.
- Strong and rigid prompter frame fixes securely to any standard tripod quick release plate.
- The prompter frame is designed to allow stand alone, in front of camera or below lens prompting.
- The black camera snood/hood is adjustable to adapt for a wide variety of cameras.
- Quick and simple assembly that requires no special tooling.
- Expandable mounting bracket system allows simple but secure installation of tablet computer
- An optional remote control is available.

Normal Tripod Set Up

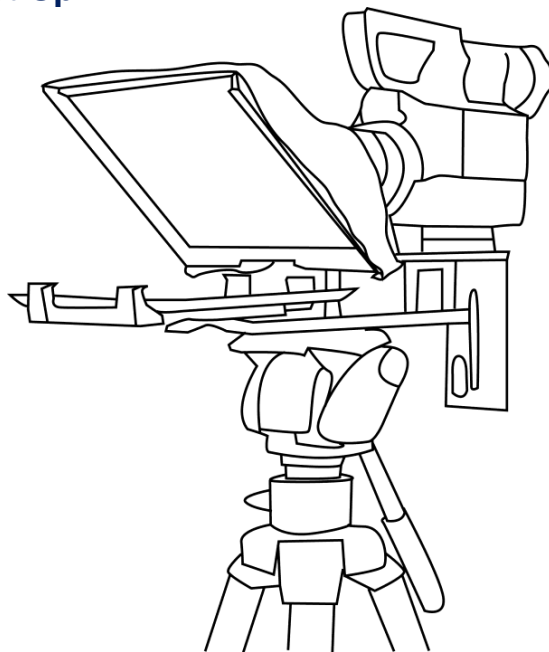

Below Camera Lens Set Up

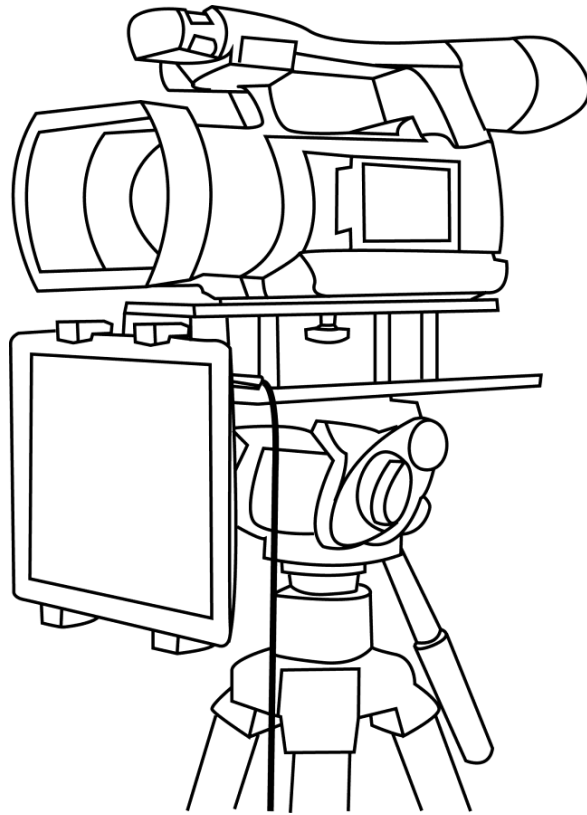

Assembly

Normal Tripod Set Up

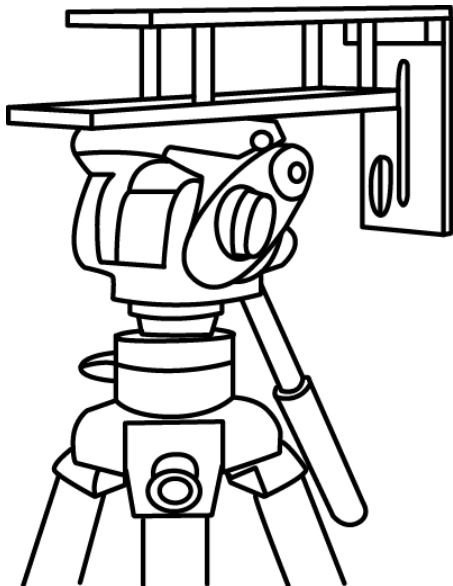

1. Attach/screw the tripod camera quick release plate to the screw holes on the base of the prompter frame, **item A**. If necessary use the adaptor screw, **item C**. Then slide and secure tripod plate, with prompter frame on top, onto the head of the tripod.

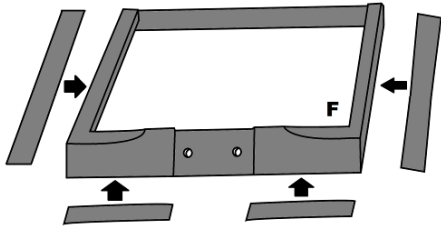

2. There are four adhesive Velcro straps are packed inside **item H**. Peel off the white paper backing before applying these straps to the Glass Frame, **item F**. Apply the two long Velcro strips to the Glass Frame edges Left side and Right side. Now apply the two smaller Velcro strips to the Bottom Left and Right sides of the Glass Frame edge. Be careful to keep them straight.

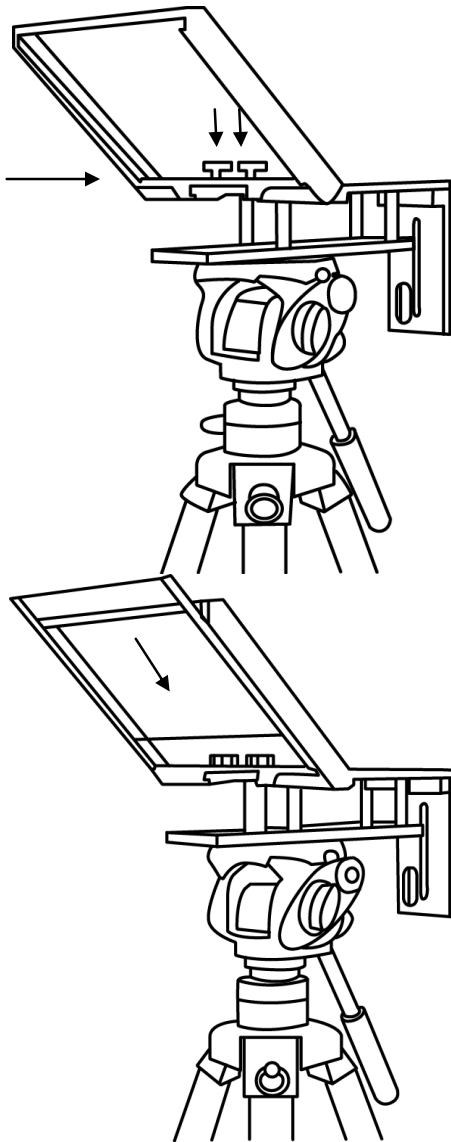

3. Slide the Glass frame, **item F**, on to the upper part of the prompter frame, **item A**, and secure with two wing nut screws, **item G**.

4. Guide/slide 60/40 Glass sheet, **item I**, into the Glass frame, **item F**.

The **Red circle sticker** should be **facing camera** position / lens.

The **Green circle sticker** should be facing **toward the on screen talent / commentator**.

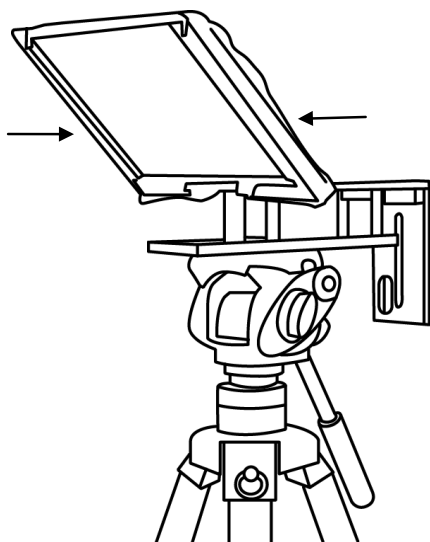

5. Apply the black camera Snood/Hood, **item H**, to the Glass Frame edges, **item F**, so the Velcro strips marry the Snood/Hood to the Glass Frame.

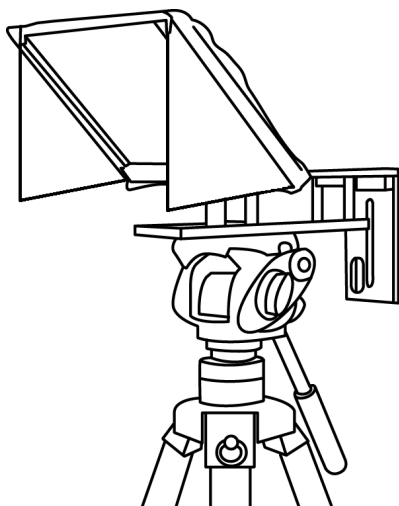

6. At this point decide if you want to fit the optional side curtains. Generally the side curtains should only be fitted when working in direct sunlight. The side curtains are applied to each side of the frame first then the Snood/Hood is fitted over the top edge of each side curtain. The curtains can help stop light from being reflected either off the mirror 60/40 glass or tablet.

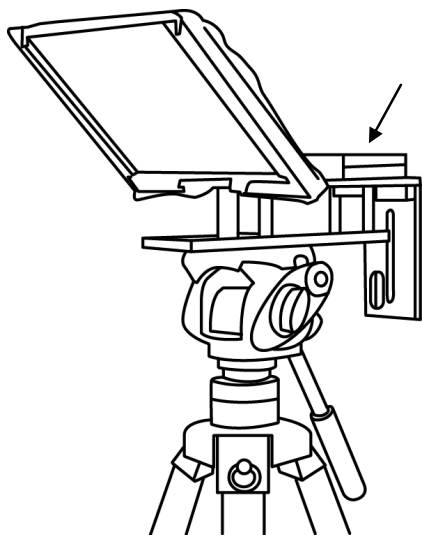

7. Decide if camera riser blocks, **item K**, are required depending on the position of the camera lens. If using 1 block use the short hex screws, **item M**, through one block but leave the centre hole empty. Turn the block over so that screws project downwards and sit in the long slot on top of the prompter frame, **item A**.

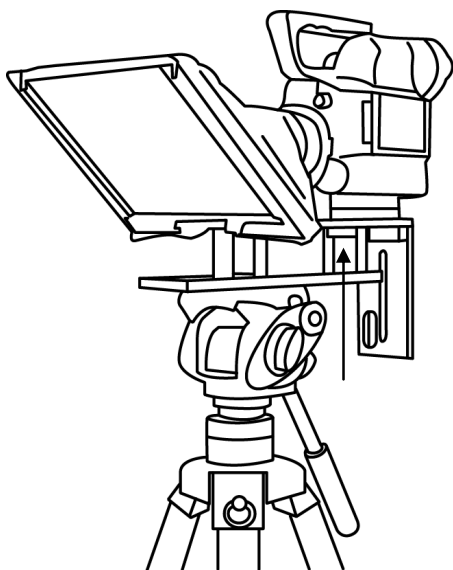

8. Fit the camera riser screw, **item O**, with washer from below the top slot, through the riser blocks centre hole and into the camera base, so the camera is secure with prompter block(s) and frame.



9. Decide if the Snood / Hood support wire, **item J**, needs to be fitted at this point.

There are three sets of holes in the Glass Frame for this wire.

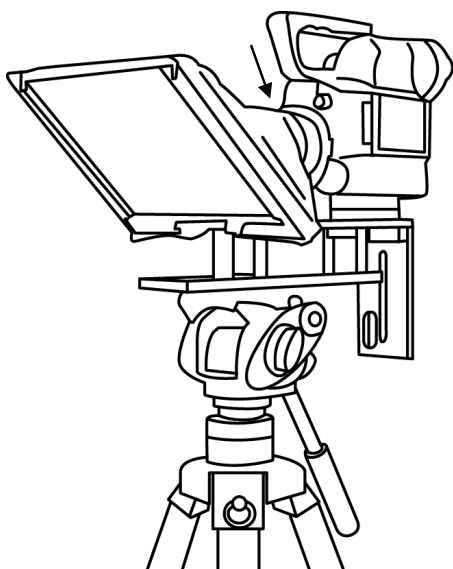

10. Pull the draw cord to secure the black camera Snood/Hood around the camera lens and to shut out light from camera side.

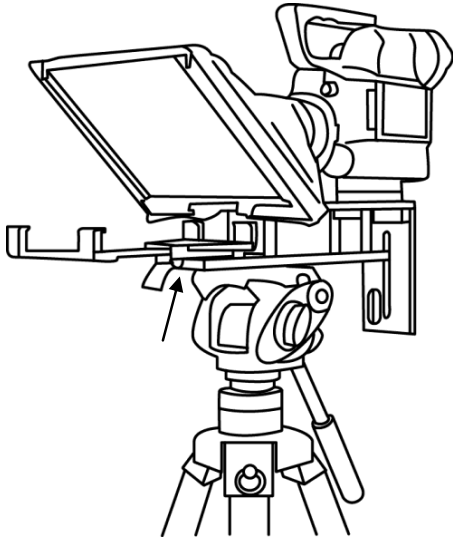

11. Fit the adjustable mounting bracket, **item E**, to the Prompter Frame just below the Glass Frame using the mounting bracket screw, **item D**, and the recess in the Prompter Frame.

Please be careful, do not over tighten the mounting bracket screw.

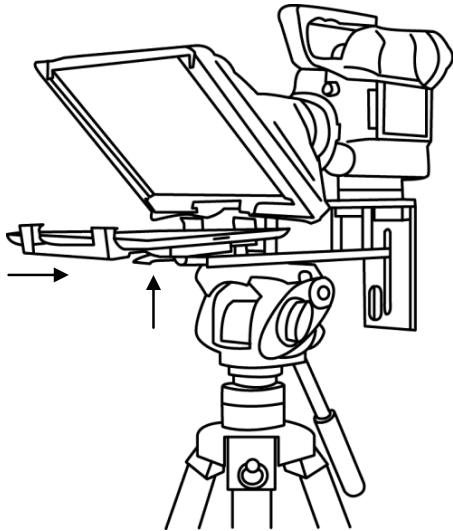

12. Turn on the tablet being used and launch the **DV Prompter** software then prepare the prompting text to be used. Also set up for the chosen optional remote control.
13. Put the configured tablet into the mounting bracket and ensure it is held securely by adjusting the size of the bracket holders for a snug fit and locking them in place. Use the locking lever on the bottom of **item E**.

14. Adjust the prompting settings where necessary.
15. Adjust the camera exposure settings as necessary. See **Camera Exposure**.
16. Read the section regarding the supplied remote control. See page 17 onwards.

Camera Exposure and the 60/40 Glass

After setting up the camera with the 60/40 glass in front of the lens adjust the camera set up and white balance. This is because the 60/40 Glass affects the camera exposure by approximately 1 stop almost like the effect of a neutral density filter. Consult your camera manual for further help and advice with its exposure and white balance settings.

Using Riser Blocks

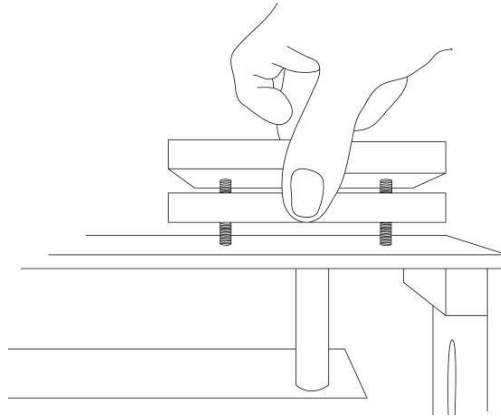

When using this TP-300 Prompter Kit you may need to use one or both riser blocks to raise the camera up so that the camera lens is positioned vertically as near to the middle of the 60/40 Glass as possible.

Two sets of screws are supplied for use with these riser blocks. The longer screws are for use with two blocks and the shorter screws when using one block. In some cases the blocks are not required.

Below Lens Assembly

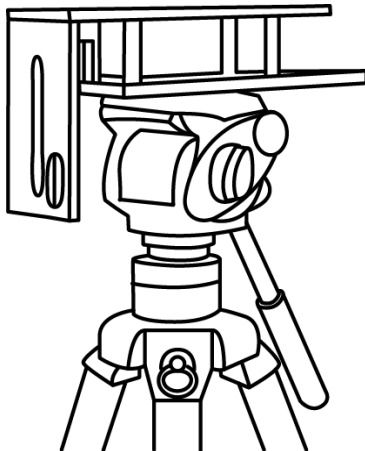

1. Attach/screw the tripod camera quick release plate to the screw holes on the base of the prompter frame, **item A**. If necessary use the adaptor screw, **item C**. Slide and secure the tripod plate, with prompter frame on top, onto the head of tripod. Ensure the vertical plate of the prompter frame is facing toward the on screen talent / commentator.

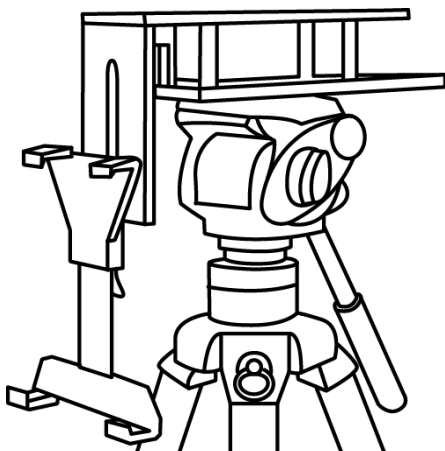

2. Use the mounting bracket screw, **item D**, to secure the mounting bracket for the tablet computer to the front of the Prompter frame's vertical plate.

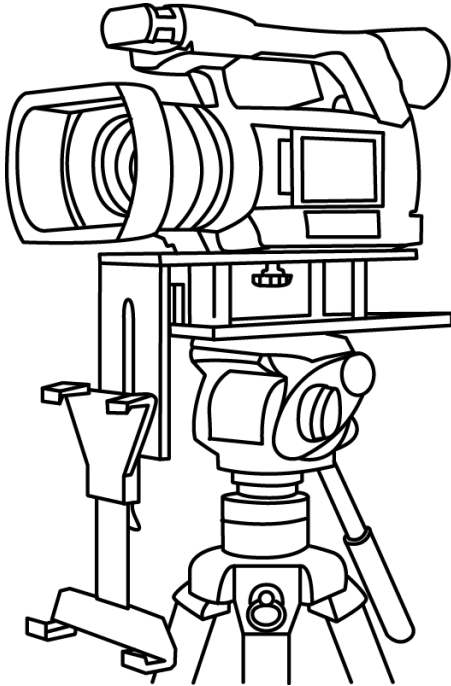

3. Fit the camera riser screw, **item O**, from below the prompter frame's long top slot. Marry the camera's base plate screw hole with Camera riser screw and secure the camera to the frame. Adjust position of the camera so the camera lens is at the edge of the prompter frame.

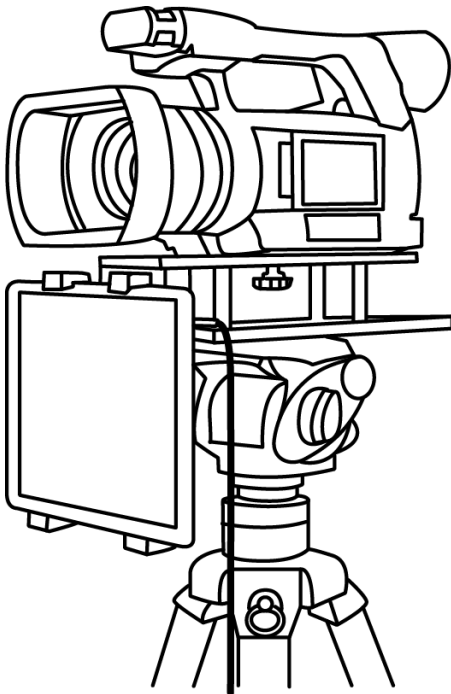

4. Turn on the tablet being used and launch the **DV Prompter** software, then prepare the prompting text to be used. Also set up for the chosen optional remote control. See page 17 also.
5. Put the configured tablet into the mounting bracket, **item E**, and ensure it is held securely by adjusting the size of the bracket holders for a snug fit and locking them in place. Use locking lever on **item E**.

6. You should now be ready to start using the Prompter.

Software Download from the App Store™

Ensure your tablet has internet access via your cellular service provider or a secure wireless connection.



Tap the **App Store™ icon** on the device Home Screen to download apps wherever you are. **Browse** the section of the store that features apps designed specifically for these devices or tap on the **Search bar** at the top/bottom of the screen and type in **Datavideo** or **DV Prompter**. Then execute the search by tapping on the Search icon to the right. You will see this software as a result listed, simply tap on the **Free** icon and then **Install**.



The App Store icon on your device will show you when an update is available for any app that you already have. Install the updates with a tap, and you'll always have the latest version of your favourite apps like **DV Prompter**.

Android App download from Google play™

Ensure your tablet has internet access via your cellular service provider or a secure wireless connection.



Tap on the **Google play™ icon** on the device Home Screen to see the latest or popular App downloads. Browse for **Apps** or tap on the magnifying glass icon to show the **Search bar**. When searching type in **DV Prompter** then execute the search by tapping on the search icon again. You will see our software as a result listed, simply tap on **DV Prompter** and choose download and install.

Android and Google play are trademarks of Google Inc.

Tablet / Device Settings

Tip: Remember to turn the tablet's Auto lock / Auto Sleep feature in Settings to 'Never' so this does not interrupt script reading when there may be very little use of the touch screen.

For the same reason it may also be wise to turn off the Cellular, SMS and Email functions/notifications of the device too before the prompting session.

Tip: Amend the prompting text before pairing the device with the Bluetooth remote control as the device's on screen keyboard will be disabled once paired.

You also need to ask yourself if you have enough battery life left in your tablet to run through the current prompting session.

It may be also necessary to remove the device from any 3rd party protective skin before it is fitted into the expandable mounting bracket.

Prompter Application Set Up

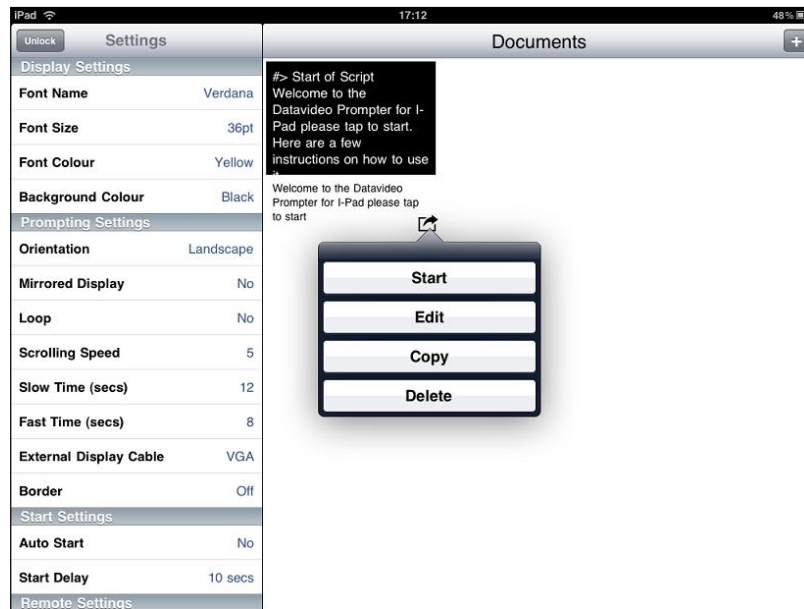

Display Settings

These settings allow the look of the text to be changed. You can change the **Font Type**, the **Font Size** of the font, the **Font Colour** and the **Background Colour**.

The software initially defaults to White, Arial, 60pt size text on a Black Background. However, you can choose from the following text or background colours; White, Black, Red, Yellow, Blue, Green or Orange. All text will be displayed in the colour chosen. Currently you cannot have different colours for different sections of the text. The size of the text can range from small (8pt) to large (72pt). However, you need to experiment a little to find the text font and size that you, or your on-screen talent, can read comfortably at a distance away from the prompter or camera.

NB: The wired remote control is approx. 3m long so this may be the maximum distance you want to work at on your own.

Prompting Settings

You use these settings to change the **Orientation** of the displayed text and if it will be **mirror** reflected off the 60/40 Glass or just used as a **normal** display. You can also set the text **Scrolling Speed** here which can be slowed down or made faster with the wired remote. A scrolling speed of 5 should be a good starting point. **Slow Time** and **Fast Time** are used to set the speed up or slow down features of the text scroll when using the speed buttons on the optional remote. If the on screen talent takes 5 to 8 seconds to read one page of text then set Slow Time to 8 seconds and Fast Time to 5 seconds. Now when the speed buttons are pressed on the remote during text play back the speed will change in equal steps between 5 and 8 seconds.

Start Settings

You can set the prompter up to automatically start scrolling text straight away or you can delay the beginning of the text scroll process by up to 10 seconds after tapping on start.

Remote Settings

Here you can choose to use no remote, an optional wired iOS remote or an optional wireless Bluetooth remote.

You can also set up text characters like ***#** that indicate a break in the scrolled text called **break markers**. These markers can then be used to quickly jump forward or backward between points in the text, when using a remote, should the running order of the production change.

NOTE: When the application is used without a remote control adverts may be displayed when first starting up the **DV Prompter** app. To remove the adverts simply connect an optional wired remote or wireless Bluetooth remote. Please speak with your supplier or dealer if you wish to purchase an optional remote control.

If using the Bluetooth remote: First amend the prompting text before pairing the device with the Bluetooth remote control as the device's own on screen keyboard will be disabled once paired.

Build Version

Only confirms the version of the app being used.

How to quickly add text into a DV Prompter document

The prompting script, or presenters' text, will probably exist as a text document from the planning stage of the production.

By copying and pasting this script text from the original document into the text body of an E-Mail it can then be quickly transferred to the smart phone.

When you attempt to forward this email using the smart phone this prompting text can then be copied into the memory of the phone. Press for a few seconds on a single word in the text and the word will be highlighted when copy option becomes available. Move the end tabs so the whole of the script is selected. Then choose or tap on the copy icon.

Now open the **DV Prompter** app and paste the copied text into a new or existing document.

Tidy up the transferred text as necessary, into sound bites and add some **Break Markers**. You now have your newly created prompting document ready to save.

Importing a text file via iTunes™ to an apple™ device

1. Connect your iPad™ to your PC or Mac via the apple USB cable (not supplied).
2. Launch iTunes™.
3. Select your iPad™ under the Devices section in the left hand pane of iTunes™.
4. Select the Apps tab at the top of the iTunes™ window.
5. Scroll down to the bottom of the page and select **DV Prompter** from the **FILE SHARING** Apps menu.
6. Click the '**Add**' file button and browse for the text file you wish to import.
7. Once transferred disconnect the apple device and restart **DV Prompter**, you should now see a new document in the list.

Using the optional wired Remote Control

Wired remote for Android™ or iOS™ devices with a headset jack input.

The remote plugs into the headset jack on the smart phone. Ensure the remote jack has a good connection with the phone socket.

How to set up the App for the wired remote control

1. Open the **DV Prompter app** on the phone or tablet device and go in to **Settings**.
2. Scroll down to and tap the **Remote** option.
3. Select the **Wired** option and your control is now ready to use.
4. Tap on the **back symbol** ↶ button to return to the **DV Prompter app** documents list.
5. Tap on the prompting document you wish to use.
6. Tap on the **Start Prompt** button.



Play Button

Once the prompting document has been chosen and launched you can **Start** or **Pause** the scrolling of the script by pressing the Green Play button on the remote control.

Stop Button

To **Stop the script** scrolling and be presented with the **back symbol** on the device's display press the Red Stop button on the remote. Tapping on the **back symbol** on the device's display **will return you to the Document list**.

Controlling the scrolling speed

To control the speed of the script whilst it is scrolling you can press the arrow up/down buttons.

The up arrow button on the remote will speed up the text scrolling.

The down arrow button on the remote will slow down the text scrolling.

Break Markers

Break Markers are a defined group of special characters such as ***#**. These are defined in the **Settings menu** of the **DV Prompter App**. See the menu option **Remote Settings** for defining these characters or Break Markers.

If these same characters ***#** are then placed into the prompting text just before each paragraph or subject change this gives the ability to jump forward or backwards through the script using the remote. There is no limit to the number of break markers that can be used within a saved text file.

To use the break markers press the Green Play button to **pause the scrolling text**. Then use the **speed up or down arrow buttons** to quickly jump forward or backwards through the script.

Using the optional Bluetooth Remote Control



This remote is designed for use with Android™ and iOS/apple™ devices.

How to charge the Bluetooth remote control

It is always best to charge the remote for *at least* an hour before a prompting session.

Plug the USB charging cable into a free USB A slot on your desktop computer and connect the remote control to the charger cable.

When the remote is charging you will see a flashing red LED light, this will stop flashing once it is fully charged.

The **DV Prompter app** will display **RECHARGE BATTERY** in the bottom right hand corner of the application window when the battery is running low in the Bluetooth remote control.

How to pair the Bluetooth remote control

1. Ensure the Bluetooth remote has been charged fully beforehand.
2. Go in to the settings menu on your phone or tablet device.
3. Go to the Bluetooth settings and **turn Bluetooth On and ensure your device is visible.**
4. **Press and hold the green button on the remote for 1 to 2 seconds until the LED starts flashing Green.**
5. You should then see **DV Prompter** appear on the handset or tablet device when searching for nearby Bluetooth devices.
6. Tap on the **DV Prompter** label to start the pairing process with the remote control.
7. The tablet or mobile device should recognise the remote as a Bluetooth keyboard type device.

If a message says that you are unsuccessful in pairing the devices then reset the remote. **To reset the Bluetooth remote** press and hold the green button until the LED flashes red on the remote. Then repeat the pairing process as above. Once paired for the first time the mobile device or tablet will then remember the Bluetooth remote making later pairing attempts easier.

How to set up the App for the Bluetooth remote control

7. Open the **DV Prompter app** on the phone or tablet device and go in to **Settings**.
8. Scroll down to and tap the **Remote** option.
9. Select the **Bluetooth** option and your control is now ready to use.
10. Tap on the **back symbol** ↶ button to return to the **DV Prompter app** documents list.
11. Tap on the prompting document you wish to use.
12. Tap on the **Start Prompt** button.



Play Button

Once the prompting document has been chosen and launched you can **Start** or **Pause** the scrolling of the script by pressing the Green Play button on the remote control.

Stop Button

To **Stop the script** scrolling and be presented with the **back symbol** on the device's display press the Red Stop button on the remote. Tapping on the **back symbol** on the device's display **will return you to the Document list**.

To turn the remote control off press and hold the Red Stop button until the LED flashes red.

NB: The Bluetooth remote control will power itself off if not used for 30 minutes

Controlling the scrolling speed

To control the speed of the script whilst it is scrolling you can press the arrow buttons.

The up arrow button on the remote will speed up the text scrolling.

The down arrow button on the remote will slow down the text scrolling.

Break Markers

Break Markers are a defined group of special characters such as ***#**. These are defined in the **Settings menu** of the **DV Prompter App**. See the menu option **Remote Settings** for defining these characters or Break Markers.

If these same characters ***#** are then placed into the prompting text just before each paragraph or subject change this gives the ability to jump forward or backwards through the script using the remote. There is no limit to the number of break markers that can be used within a saved text file.

To use the break markers press the Green Play button to **pause the scrolling text**. Then use the **speed up or down arrow buttons** to quickly jump forward or backwards through the script.

Cleaning the 60/40 Glass sheet

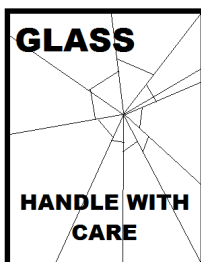

This product contains a sheet of 60/40 glass please handle it with care.

To avoid a risk of damage or injury please follow this instruction manual and use caution when transporting, un-packing, cleaning, assembling or dis-assembling this part of the product.

Datavideo recommend cleaning the glass regularly to remove dust and finger print marks. This will ensure the best image quality is recorded when the camera is looking through the glass.

Never attempt to clean the glass whilst it is mounted in the prompter instead remove it carefully from the prompter, clean the glass and then re-install it into the prompter frame. Handle the glass carefully using the cloth covered edges of the glass at all times.

To retain the required qualities of the glass and to avoid scratching the glass during cleaning.

- ***Never use*** abrasive cloths, pads or abrasive based cleaning fluids on the glass.
- ***Never use*** cleaning fluids based on an acid or vinegar solution.

Place the glass on a soft, stable, dirt and lint free work surface such as a table with a clean cloth already laid out on it. Then use a second clean, lint free, soft cloth to clean the glass.

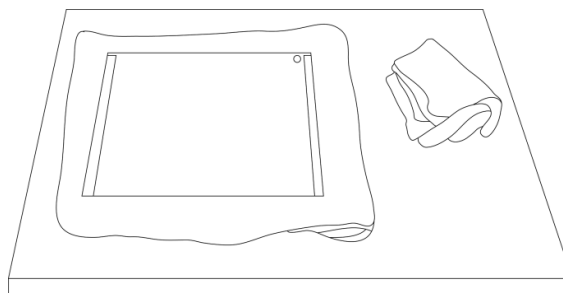

Do not apply cleaning fluids to the glass directly, instead apply or spray a small amount of the cleaning fluid onto the cloth. Proceed to clean the glass and work in a light circular motion with the cloth. Ensure all finger marks and streaks are gone before turning the glass over and repeating with the other side.

Once finished re-install the glass back into the prompter hood, again using the cloth covered edges only. ***Ensure the green circle sticker on the glass is facing you*** and the red circle sticker is facing the camera lens. Reseat/secure the camera hood if necessary.

Adjusting the lower rail of the prompter frame

Depending on the size and shape of the tablet computer used, it may be necessary to adjust the position of the lower rail of the prompter frame (Item A on page 5) to move the position of the tablet. The lower rail of the prompter frame can be removed and relocated either toward the front or further to the rear. To do this you will need the hex tools provided with the TP-300 kit (Item B on page 5).

1. First carefully dismantle the current TP-300 set up to remove the prompter frame (Item A).
2. Lay the prompter frame upside down on a flat surface so you can see the lower hex screws.
3. Use the larger hex tool (Item B) to remove the lower rail from its current position. Leave the pillars of the frame connected to the other rail. Be careful not to lose any Hex screws.
4. Re-locate the lower rail to its new position, either one hole backward or forward of where it was originally.
5. Secure the rail in its new position using the same Hex tool and screws.
6. You can now rebuild the TP-300 set up with the modified prompter frame by using the supplied assembly directions from page 7 onwards.

Specifications

Text File Format	Copy and paste from email or text file
Reading Range	3m (9ft) approx
Prompter wired remote control cable length	3m (9ft) approx
Prompter remote control battery life	2 years at average usage
Replacement remote control	Speak to your supplier for details
Prompter Size	
Width:	250 mm (9.84 inches)
Height:	210 mm (8.27 inches)
Depth:	447 mm (17.6 inches)
Expandable Mounting Bracket	
Sizes:	105 mm (Minimum tablet width)
	198 mm (Maximum tablet width)
Nett Weight:	Kit: 1.9 Kg (4.2 lbs)
Packed weight: (Gross)	Kit: 2.8 Kg (6.18 lbs)

Service and Support

It is our goal to make your products ownership a satisfying experience. Our support staff are available to assist you in setting up and operating your system. Please refer to our web site www.datavideo.com for answers to common questions, support requests or contact your local office below.

Datavideo Global Website: www.datavideo.com

Datavideo Corporation

Tel: +1 562 696 2324	Fax: +1 562-698-6930	E-Mail: contactus@datavideo.us
----------------------	----------------------	----------------------------------------------------------------------------

Datavideo Technologies Europe BV

Tel: +31-30-261-96-56	Fax: +31-30 261-96-57	E-Mail: service@datavideo.nl
-----------------------	-----------------------	------------------------------------------------------------------------

Datavideo UK Limited

Tel: +44 1457 851 000	Fax: +44 1457 850 964	E-Mail: sales@datavideo.co.uk
-----------------------	-----------------------	--------------------------------------------------------------------------

Datavideo Technologies Co., Ltd

Tel: +886 2 8227 2888	Fax: +886-2-8227-2777	E-mail: service@datavideo.com.tw
-----------------------	-----------------------	--------------------------------------------------------------------------------

Datavideo Technologies China Co., Ltd

Tel: +86 21-5603 6599	Fax: +86 21-5603 6770	E-mail: service@datavideo.cn
-----------------------	-----------------------	------------------------------------------------------------------------

Datavideo Technologies (S) PTE Ltd

Tel: +65-6749 6866	Fax: +65-6749 3266	E-mail: sales@datavideo.sg
--------------------	--------------------	--------------------------------------------------------------------

Datavideo HK Ltd

Tel: +852 2833 1981	Fax: +852-2833-9916	E-mail: info@datavideo.com.hk
---------------------	---------------------	--------------------------------------------------------------------------

Datavideo France s.a.r.l.

Tel: +33 1 60 37 02 46	Fax: +33 1 60 37 67 32	E-mail: info@datavideo.fr
------------------------	------------------------	------------------------------------------------------------------

Datavideo Technologies India PVT LTD.

Tel: +91 120 4309120	Fax: +91 120 4309121	E-mail: sales@datavideo.in
----------------------	----------------------	--------------------------------------------------------------------

All the trademarks are the properties of their respective owners.

Datavideo Technologies Co., Ltd. All rights reserved 2013.

Rev Date: 03/04/2013

P/N: TP-300_E6_A4